

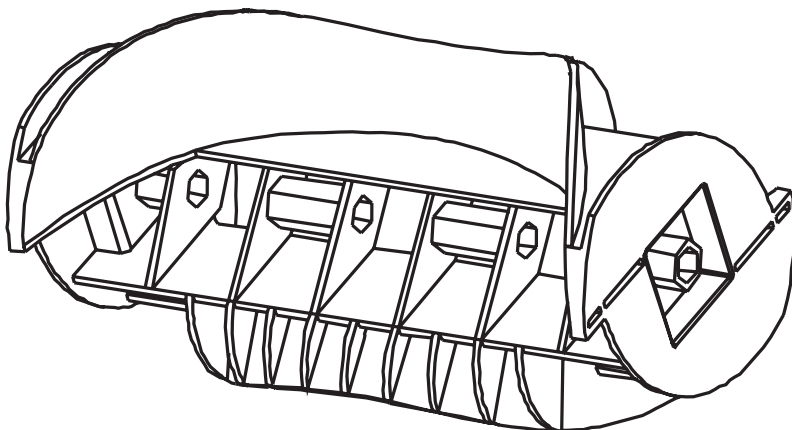

AUGER REPLACEMENT QUICK GUIDE

(For Snow Joe models 323E + iON13SS)

Model SJ-SHVAUG



**If you have any questions or comments, please call the
Snow Joe® + Sun Joe® customer service department at:**

1-866-SNOWJOE (1-866-766-9563)

© 2014 by Snow Joe®, LLC
All rights reserved. Original instructions.

SAVE THESE INSTRUCTIONS

Fig. 1

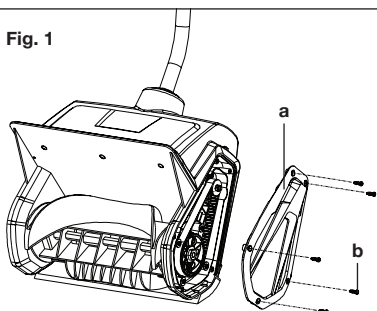

Fig. 2

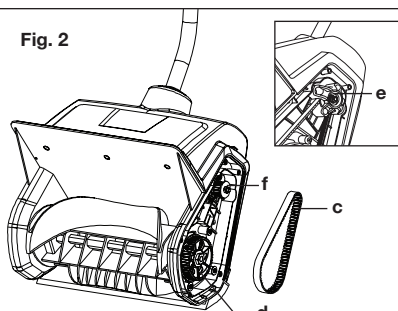

Fig. 3

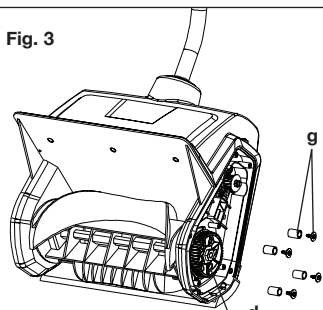

Fig. 4

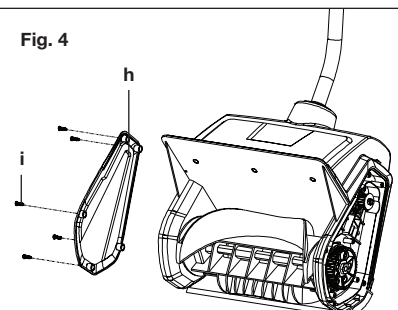

Fig. 5

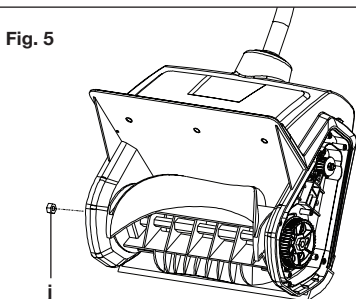

Fig. 6

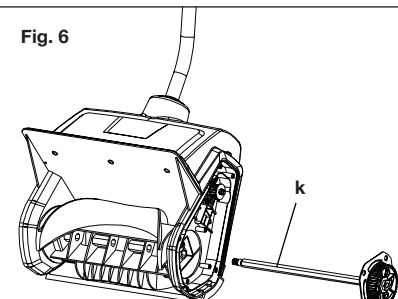

Fig. 7

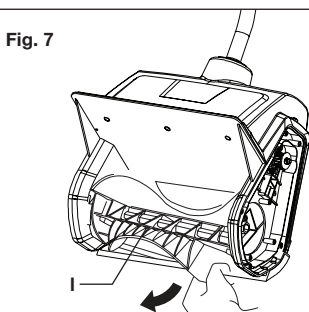
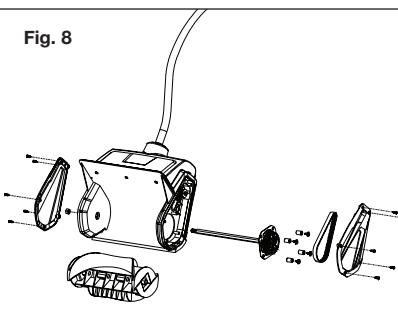

Fig. 8



Replacing the Auger

⚠ WARNING! Before performing any maintenance on your corded or cordless snow shovel, make sure to disconnect the power supply by either removing the extension cord from the electrical outlet (for model 323E) or by removing the battery from its housing (for model iON13SS).

1. Disassemble the left side cover (a) by removing the five screws (b) that hold it in place (Fig. 1).
2. Remove the belt (c) from the drive wheel (d) (Fig. 2).
3. Remove the screws and the bushings (g) from the drive wheel (d) (Fig. 3).
4. Disassemble the right side cover (h) by removing the five screws (i) that hold it in place (Fig. 4).
5. Secure the auger as you disassemble the auger assembly nut (j) (Fig. 5).
6. Remove the auger axle set (k) (Fig. 6).
7. Remove the old auger (l) from the housing (Fig. 7).
8. Install the replacement auger by following the above steps in reverse order (Fig. 8).

NOTE: To reinstall the belt (c), roll the belt onto the motor bearing (f), then roll the belt onto the top of the drive wheel (d) by rotating the drive wheel counterclockwise as the belt grips the top of the drive wheel.

NOTE: If you have any questions, please call the Snow Joe® + Sun Joe® customer service department at 1-866-SNOWJOE (1-866-766-9563) for assistance.



snowjoe.com