



**OPERATOR'S MANUAL**

A Division of Snow Joe®, LLC

## **PUSH LAWN SWEEPER**

**26-INCH**

**Model SJSW26M-RM**

Form No. SJ-SJSW26M-RM-880E-V1

# **THANKS FOR YOUR PURCHASE OF A REMANUFACTURED PRODUCT.**

To make sure you get the most out of your product, be sure to register online at

**[snowjoe.com](https://snowjoe.com)**

to enjoy full product support.

AFFIX SERIAL NUMBER LABEL



## OPERATOR'S MANUAL

A Division of Snow Joe®, LLC

# PUSH LAWN SWEEPER

## 26-INCH

**Model SJSW26M-RM**

Form No. SJ-SJSW26M-RM-880E-V1

## IMPORTANT!

### Safety Instructions

### All Operators Must Read These Instructions Before Use

Always follow these safety guidelines. Failure to do so may result in serious bodily injury or property damage.

## About This Push Lawn Sweeper

This heavy-duty push sweeper makes yard work a breeze. The steel and poly construction is durable and lightweight, making it easy to push, rust-resistant, and easy to clean. The extra large sweeping span makes the job easy and saves time when cleaning different types of debris from grass, such as twigs, paper, leaves and much more. The push sweeper features an easy one-handed function to adjust the brush head. It can be stored in your shed, garage, and on the wall. The large 52.3 gal (198 l) hopper bag makes loading and unloading easy and convenient.

## General Safety

**⚠️ WARNING!** The warnings, cautions, and instructions outlined in this manual cannot cover all possible conditions or situations that may occur. It must be understood by the operator that common sense and caution are factors which cannot be built into this product and must be supplied by the operator.

1. Do not at any time carry passengers (sitting or standing) on the sweeper.
2. Do not permit children to operate sweeper.
3. Do not push sweeper too close to a fire; the hopper and the brushes will burn.
4. Do not exceed the maximum capacity of the hopper bag at 52.3 gal (198 l).
5. Use caution when operating the sweeper on rough terrain, ditches, and hillsides to prevent tipping.
6. This sweeper is not meant for street or highway use. Watch for traffic when sweeping near roadways.

7. Sweeper should be inspected for damage after striking a foreign object.
8. Replace or repair damaged or worn parts immediately before operating the equipment.
9. Follow all maintenance instructions outlined in this manual.
10. Do not pick up toxic, carcinogenic, combustible, or other hazardous materials such as asbestos, arsenic, barium, beryllium, lead, pesticides, or other health-endangering materials.
11. Do not pick-up burning cigarettes or other smoking materials, ashes, matches, or similar materials.
12. To avoid personal injury, use heavy gloves when removing glass, metal, or other sharp materials from the hopper bag.
13. The hopper bag should be emptied after each use.
14. This push sweeper is not designed for use with liquids.
15. Do not expose to rain. Store indoors.
16. The operation of a utility sweeper can result in foreign substances being blown into eyes. Always wear safety goggles when operating the sweeper.
17. **STAY ALERT.** Watch what you are doing and use common sense. Do not use the push sweeper when tired, distracted, or under the influence of drugs, alcohol, or medication causing diminished control.

# Know Your Push Sweeper

1. Handle frame
2. Long bag rod
3. Hopper bag
4. Supporting leg (2)
5. Wheel (2)
6. Sweeper assembly
7. Brush height adjustment locking knob
8. Height adjustment tube
9. Short bag rod
10. M6 x 30 carriage bolt (8)
11. Bag rod clip (4)
12. Lock washer (4)
13. M6 nylon lock nut (4)
14. Flat washer (4)
15. Handle knob (4)
16. Wrench

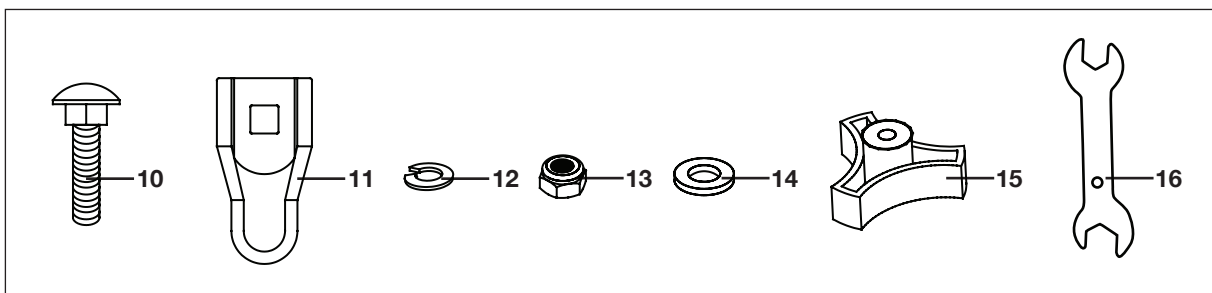
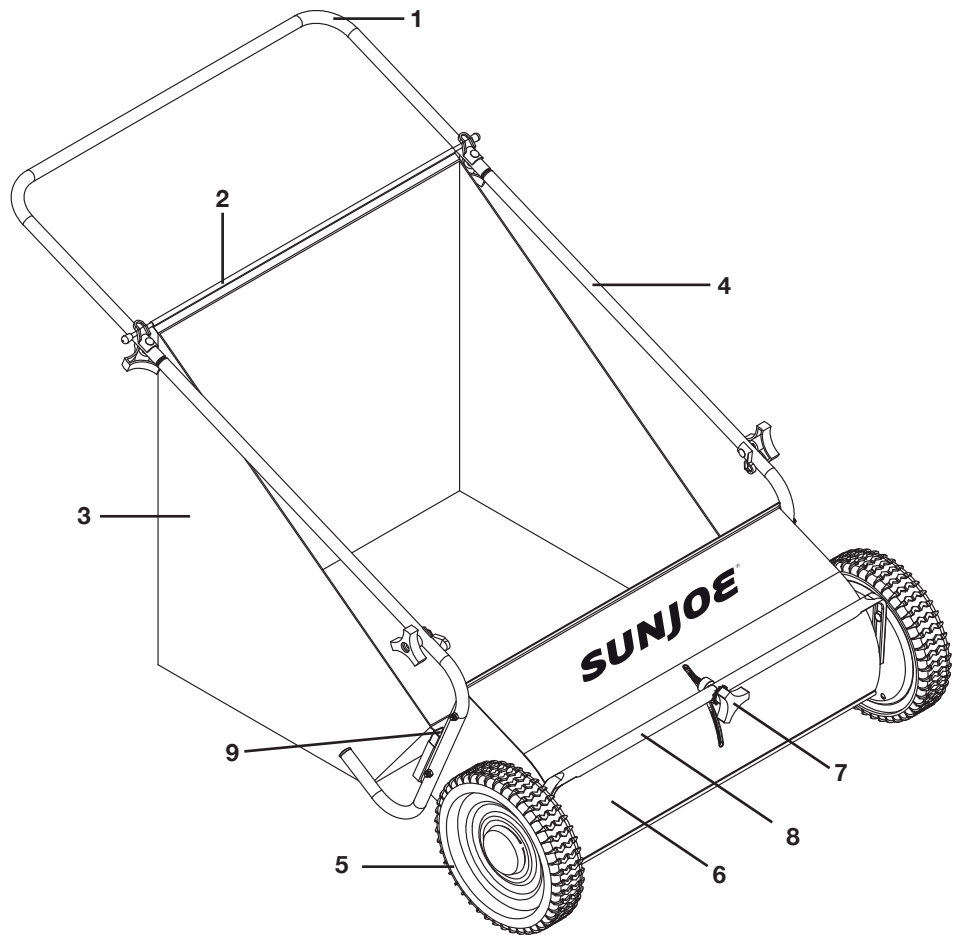

## Technical Data

Material..... Steel + rubber  
 Drive Type..... Walk behind (push)  
 Brush to Wheel Ratio ..... 4.25 : 1  
 Height..... Adjustable  
 Brush Diameter..... 10 in. (25.4 cm)

Sweeping Width ..... 26 in. (66 cm)  
 Hopper Bag Capacity..... 52.3 gal (198 l)  
 Wheel Size..... 9.8 in. (25 cm)  
 Weight ..... 34 lbs (15.4 kg)

# Assembly

Your push lawn sweeper requires assembly. Account for all parts and hardware before beginning assemble. If any parts are missing or damaged, or if you have any questions or need additional instructions, please call the Snow Joe® + Sun Joe® customer service center at 1-866-SNOWJOE (1-866-766-9563).

## Tools needed:

- 10 mm wrench
1. Attach the supporting leg to the sweeper assembly and secure with M6 x 30 carriage bolt, and M6 nylon lock nut (Fig. 1). Do not tighten yet. Repeat for the other side.

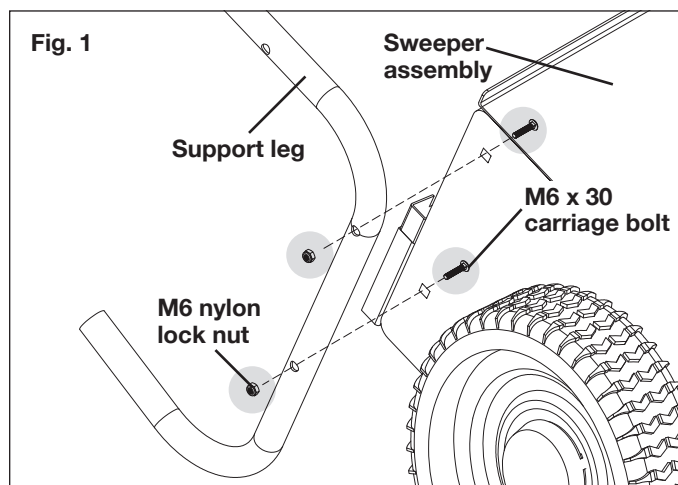

2. Assemble the handle frame over the supporting legs. Align the holes in the handle frame and supporting legs (Fig. 2).

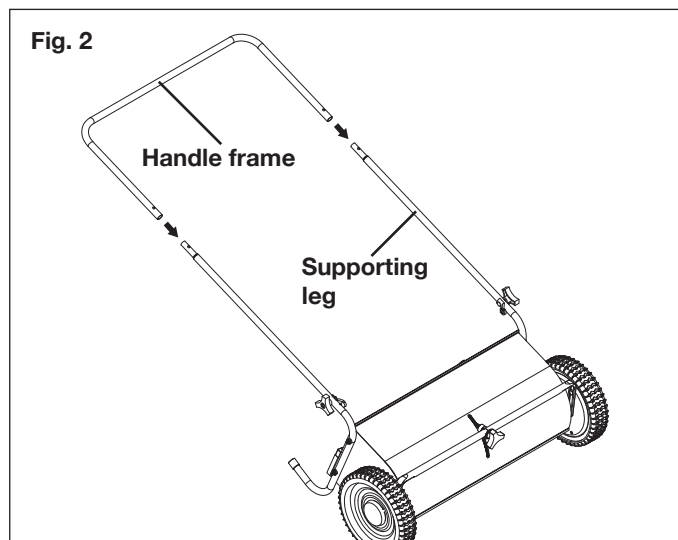

3. Secure the supporting legs and the handle frame with two M6 x 30 carriage bolts, bag rod clips, flat washers, lock washers, and handle knobs (Fig. 3).

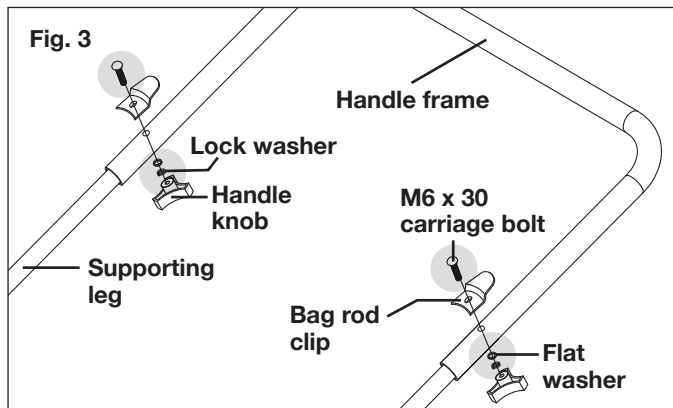

4. Fully tighten all hardware in step 1.
5. Put two bag rod clips on the inside of each supporting leg, secure by a M6 x 30 carriage bolt, a flat washer, a lock washer, and a handle knob (Fig. 4).

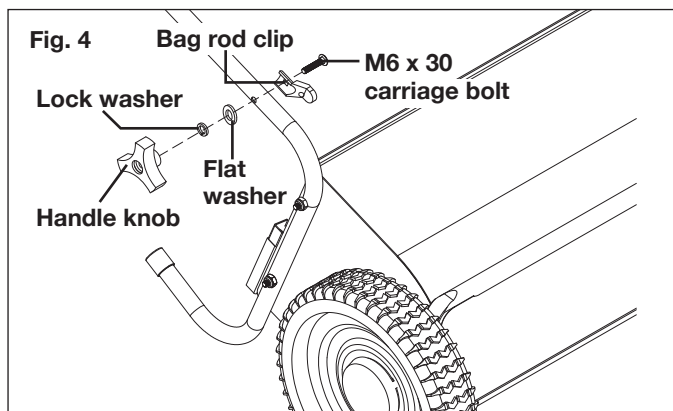

6. Slide the long bag rod through the top of the hopper bag along the stitched area. Slide the short bag rod through the bottom of the hopper bag along the stitched area. (Fig. 5).

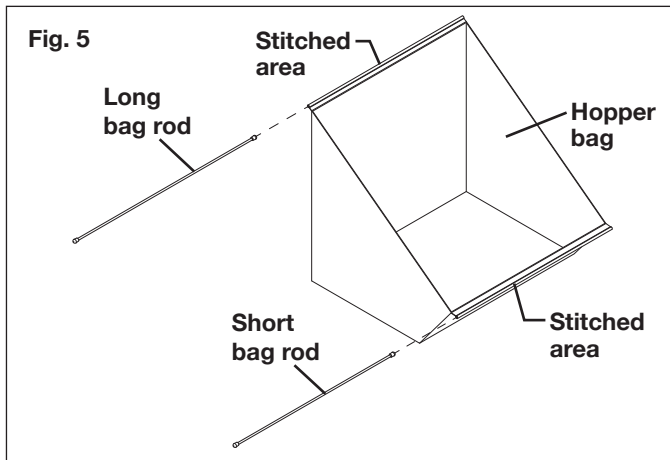

7. Place the hopper bag assembly on the sweeper and frame assembly by inserting the long bag rod in the two rod clips on the handle frame, and the short bag rod into the two openings on each side of the housing assembly (Figs. 6 – 8).

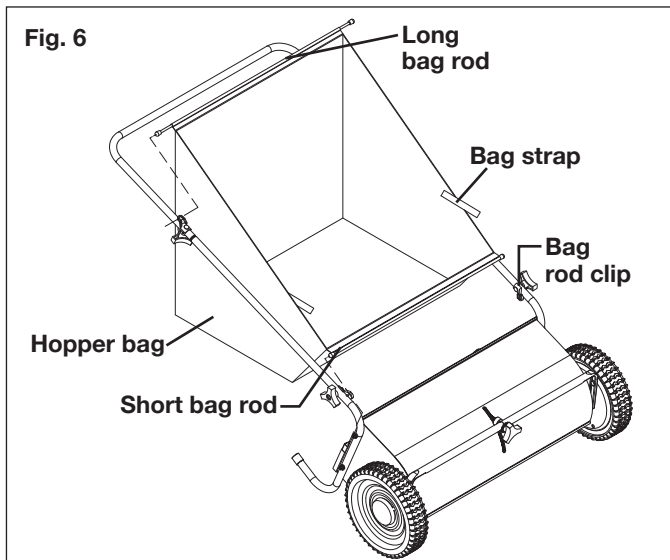

Fig. 7

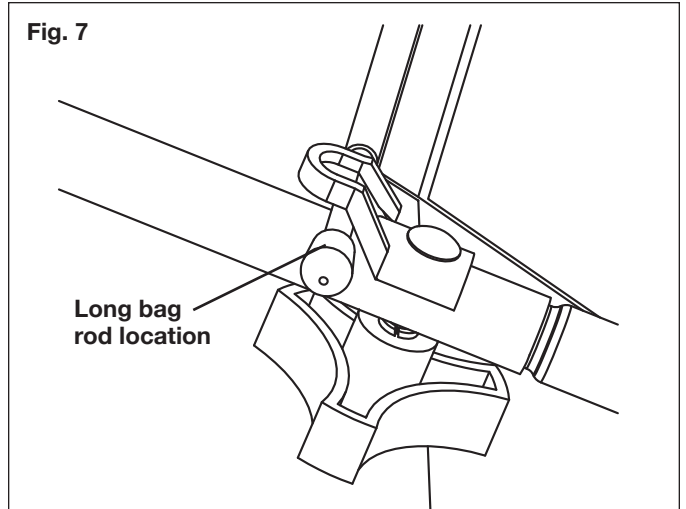
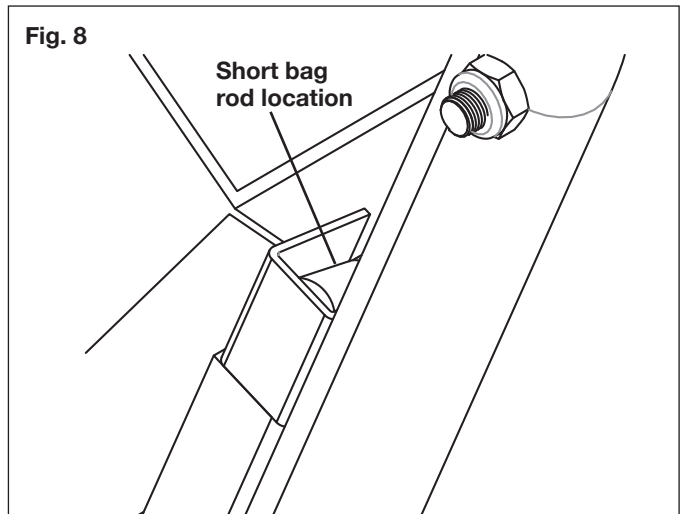
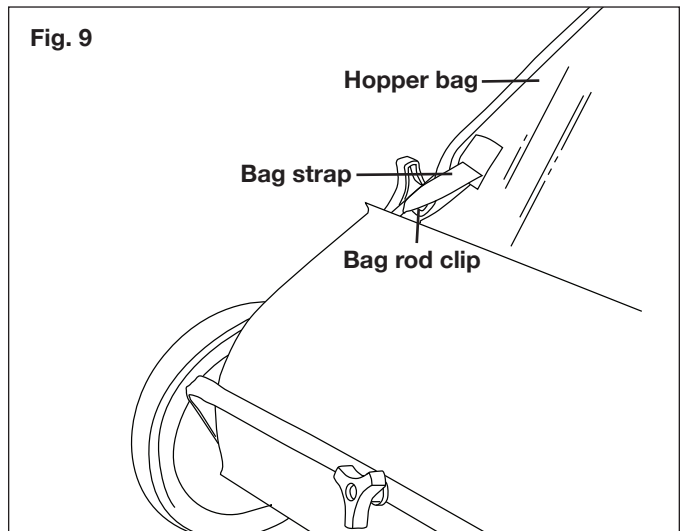

Fig. 8



8. Hook the plastic straps on the bag flaps under the bag clips on the supporting legs (Fig. 9).

Fig. 9



# Operation

**⚠WARNING!** Before using the push sweeper, make sure the sweeper is correctly assembled and all hardware is fully tightened.

## Brush Height Adjustment

1. Unlock the height adjustment lock by turning the locking knob counter-clockwise (Fig. 10).

Fig. 10

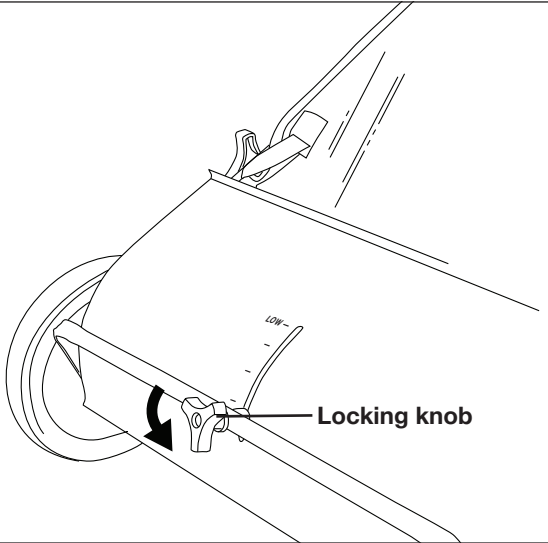

2. Adjust the brush height by lifting the handle up and down. Lock your desired height by turning the locking knob clockwise (Fig. 11).

**NOTE:** Sometimes you may need your hand to slide the height adjustment tube.

Fig. 11

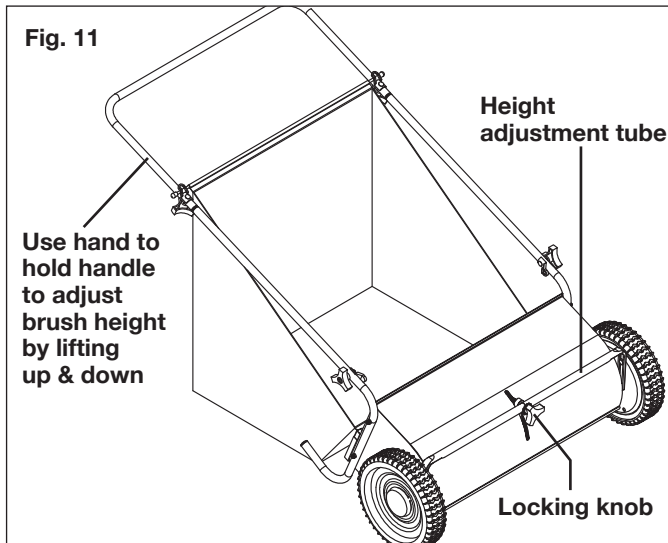

## Basic Sweeping Method

Push sweeper forward at normal walking speed; it does not operate when pulled backwards.

**NOTE:** Always mow the grass to an even height before sweeping.

## Dumping Hopper Bag

1. To dump the hopper bag, tip the sweeper forward allowing the material to fall out.
2. You can also take the hopper bag off of the sweeper to dump.

**⚠WARNING!** Always dump hopper bag after each use. Damp or wet grass and leaves will cause damage to hopper if stored for an extended period of time.

**⚠WARNING!** DO NOT dump or unload the sweeper too close to fire as the brushes and the hopper bag can be destroyed by excessive heat of flame.

# Maintenance

## General

- After each use, dump and clean the hopper.
- Rinse/dry inside and outside of the sweeper after each use.
- Periodically check all nuts, bolts, and screws for proper tightness.
- Annually clean out and lightly lubricate parts.
- Use a glossy enamel spray paint to touch up scratched or worn painted metal surface.
- Never exceed the hopper load capacity rating of 52.3 gal (198 l) It will damage the hopper bag.

## Lubrication

The bearings in the sweeper have been pre-lubricated at the factory. However it's recommended that a few drops of light oil should be added to the brush shaft bearings twice a year. Also, the gear should be cleaned every two years. After cleaning apply an even coat of light grease.

1. Use a screw driver to pop off the hub cap (Fig. 12).

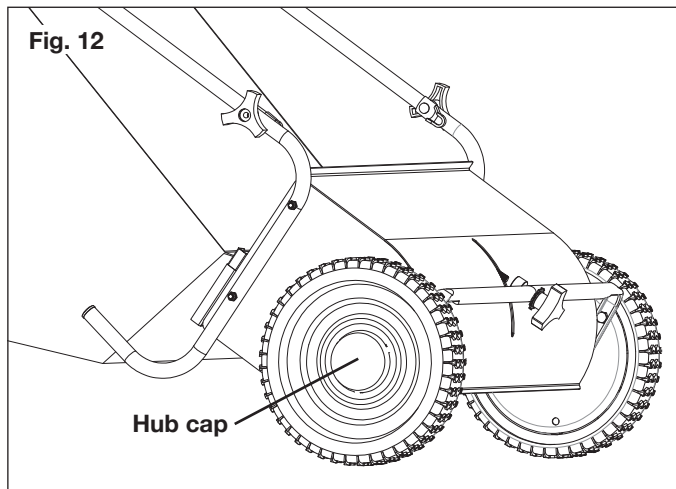

2. To remove the wheel, take out the circlip and the flat washer; you will see the gear and the shaft (Fig. 13).

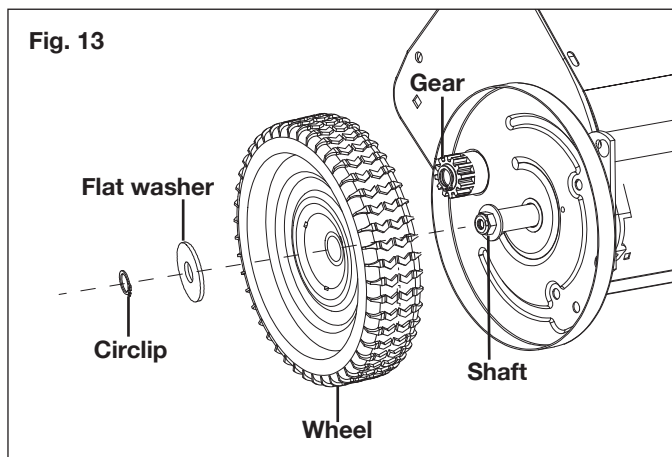

3. Remove the circlip on the gear, the gear can be taken off easily (Fig. 14).

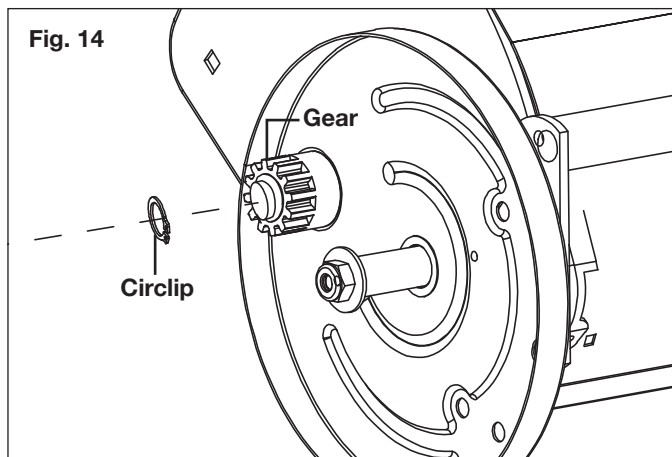

4. Clean the gear and lubricate the shaft as needed, then reassemble the wheel in a reverse sequence.

## Brush Replacement

1. Before replacing the brush, remove the hopper bag from the sweeper, and flip the sweeper over.
2. Remove all the nuts and bolts on the brush retainers used for securing the brushes (Fig. 15).

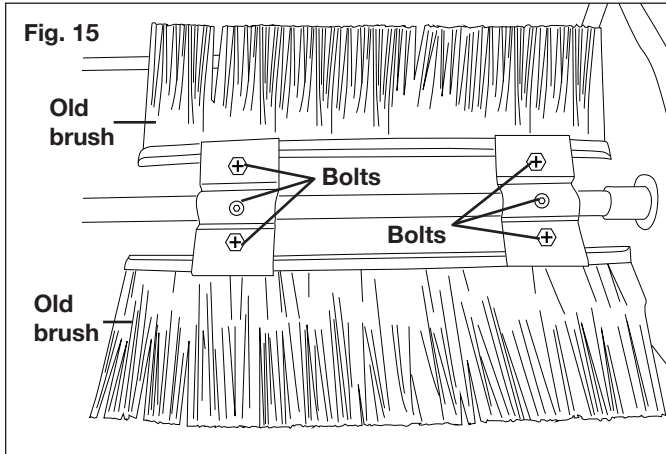

3. Remove the old brushes, the long brush retainer, and the short brush retainer from the sweeper (Fig. 16).

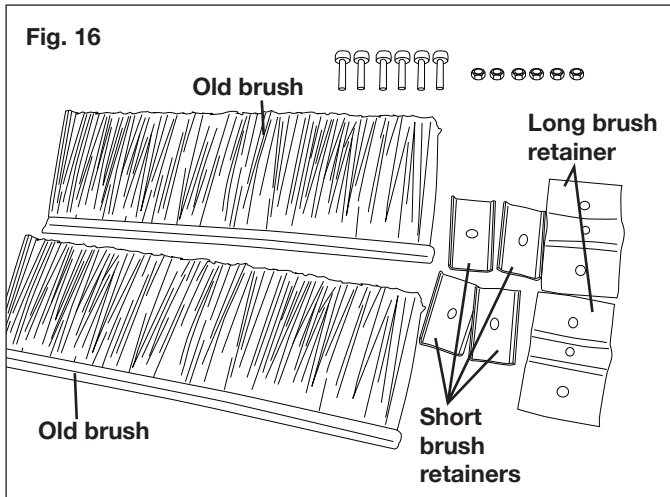

4. Insert new brushes between the long brush retainer and the short brush retainer; fix with M6 nuts and hex bolts (Fig. 17).

**Fig. 17**

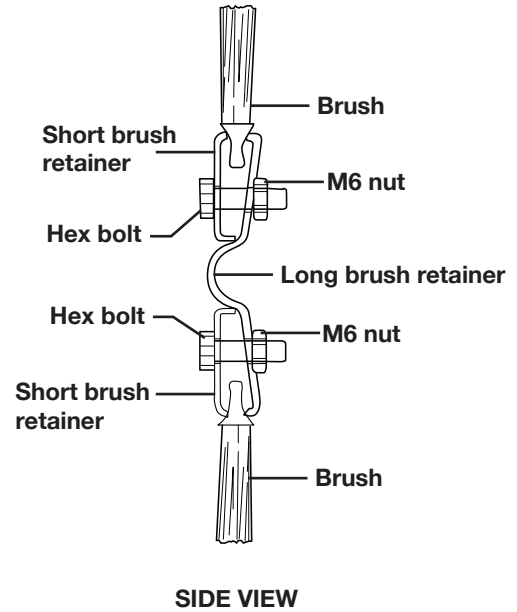

5. Fit the brush assembly onto the brush shaft; fix with a M5 nut and a M5 bolt (Fig. 18).

**Fig. 18**

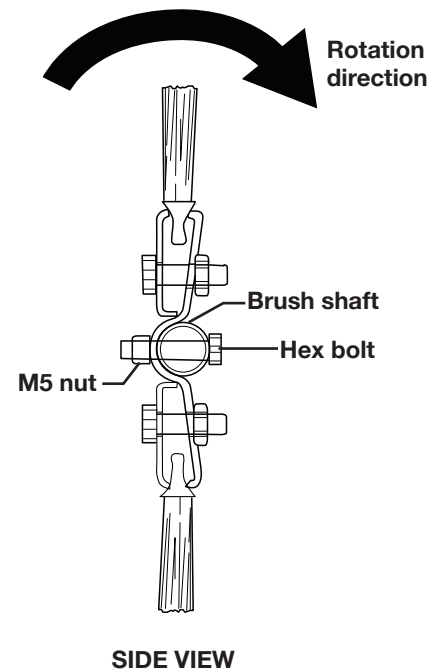



6. Repeat the steps to install the remaining brush.

**NOTE:** The two set of brushes should remain vertical to each other after assembly, as shown (Fig. 19).

**Fig. 19**

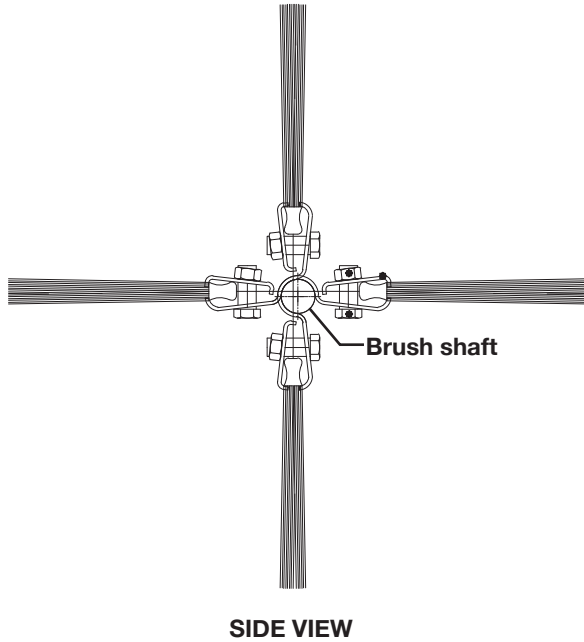

## Service + Support

If your Sun Joe® SJSW26M-RM lawn sweeper requires service or maintenance, please call Snow Joe® + Sun Joe® customer service at 1-866-SNOWJOE (1-866-766-9563) for assistance.

## Model + Serial Numbers

When contacting the company or arranging service from an authorized dealer, you will need to provide the model and serial numbers, which can be found on the decal located on the sweeper. Copy these numbers into the space provided below.

Model #:														
S	J	S	W	2	6	M	-	R	M					
Serial #:														

## Storage

1. Store indoors or in protected area during severe weather and winter months.
2. Never allow anything left in the hopper bag to remain for an extended period of time.
3. Before storing, make sure the sweeper is dry and clean.

[illegible]



## SNOW JOE® + SUN JOE® REFURBISHED GOODS WARRANTY

### GENERAL CONDITIONS:

Snow Joe® + Sun Joe® operating under Snow Joe®, LLC warrants this refurbished product to the original purchaser for 90 days against defects in material or workmanship when used for normal residential purposes. If a replacement part or product is needed, it will be sent free of charge to the original purchaser except as noted below.

The duration of this warranty applies only if the product is put to personal use around the household. It is the owner's responsibility to correctly perform all maintenance and minor adjustments explained in the owner's manual.

### HOW TO OBTAIN YOUR REPLACEMENT PART OR PRODUCT:

To obtain a replacement part or product, please visit [snowjoe.com/help](http://snowjoe.com/help) or email us at [help@snowjoe.com](mailto:help@snowjoe.com) for instructions. Please be sure to register your unit beforehand to speed up this process. Certain products may require a serial number, typically found on the decal affixed to the housing or guard of your product. All products require a valid proof of purchase.

### EXCLUSIONS:

- Wearing parts like belts, augers, chains and tines are not covered under this warranty. Wearing parts can be purchased at [snowjoe.com](http://snowjoe.com) or by calling 1-866-SNOWJOE (1-866-766-9563).
- Batteries are covered in full for 90-days from the date of purchase.

Snow Joe® + Sun Joe® may from time to time change the design of its products. Nothing contained in this warranty shall be construed as obligating Snow Joe® + Sun Joe® to incorporate such design changes into previously manufactured products, nor shall such changes be construed as an admission that previous designs were defective.

This warranty is intended to cover product defects only. Snow Joe®, LLC is not liable for indirect, incidental or consequential damages in connection with the use or misuse of the Snow Joe® + Sun Joe® products covered by this warranty. This warranty does not cover any cost or expense incurred by the purchaser in providing substitute equipment or service during reasonable periods of malfunction or non-use of this product while waiting for a replacement part or unit under this warranty. Some states do not allow exclusions of incidental or consequential damages so the above exclusions may not apply in all states. This warranty may give you specific legal rights in your state.

### HOW TO REACH US:

We're here to help Monday through Friday from 9AM to 6PM EST. You can reach us at 1-866-SNOWJOE (1-866-766-9563), online at [snowjoe.com](http://snowjoe.com), via email at [help@snowjoe.com](mailto:help@snowjoe.com) or tweet us @snowjoe.

### EXPORTS:

Customers who have purchased Snow Joe® + Sun Joe® products exported from the United States and Canada should contact their Snow Joe® + Sun Joe® distributor (dealer) to obtain information applicable to your country, province or state. If for any reason, you are not satisfied with the distributor's service, or if you have difficulty obtaining warranty information, contact your Snow Joe® + Sun Joe® seller. If in the event your efforts are unsatisfactory, please reach out to us directly.



[snowjoe.com](http://snowjoe.com)